



COLÉGIO ALMADA NEGREIROS

CAMPOLIDE



NOVAFCSH



**COLÉGIO ALMADA NEGREIROS,
CAMPOLIDE**

BUILDING HISTORY

The Colégio Almada Negreiros, known for many years as Colégio dos Jesuítas, was gradually built in the beginning of the second half of the 19th century, at the time administered by the Society of Jesus. Before being occupied by the NOVA University of Lisbon, it was also home to the “Batalhão de Caçadores 5”, which would leave the building in the 1970s.

HOW TO GET HERE

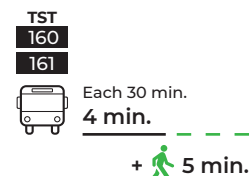
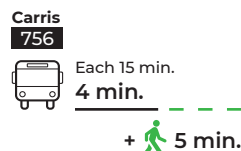
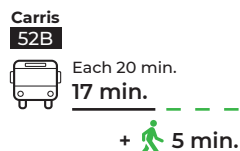

SHUTTLE



**Crowding or stocking
28 seats**
Travel is not allowed standing

**Ramp for reduced
mobility**

OUTPUT CAMPOLIDE	10 min.	OUTPUT AV. BERNA
09h35		09h45
10h00		10h10
11h35		11h45
12h00		12h10
13h35		13h45
14h00		14h10
15h35		15h45
16h00		16h10
17h40		17h50

NOVA FCSH ensures a free shuttle service between the two spaces. Each trip is direct and takes approximately 10 minutes.

The starting point at Av. de Berna will be the CARRIS/TST stop in front of the main entrance. The stop at Colégio Almada Negreiros will be at the entrance via Rua da Mesquita.

Any member of the community can use this vehicle, marked as belonging to NOVA FCSH. To prove it, students must display their student card. Teachers, researchers or employees can use their business card or request a statement from the Faculty to access the shuttle.

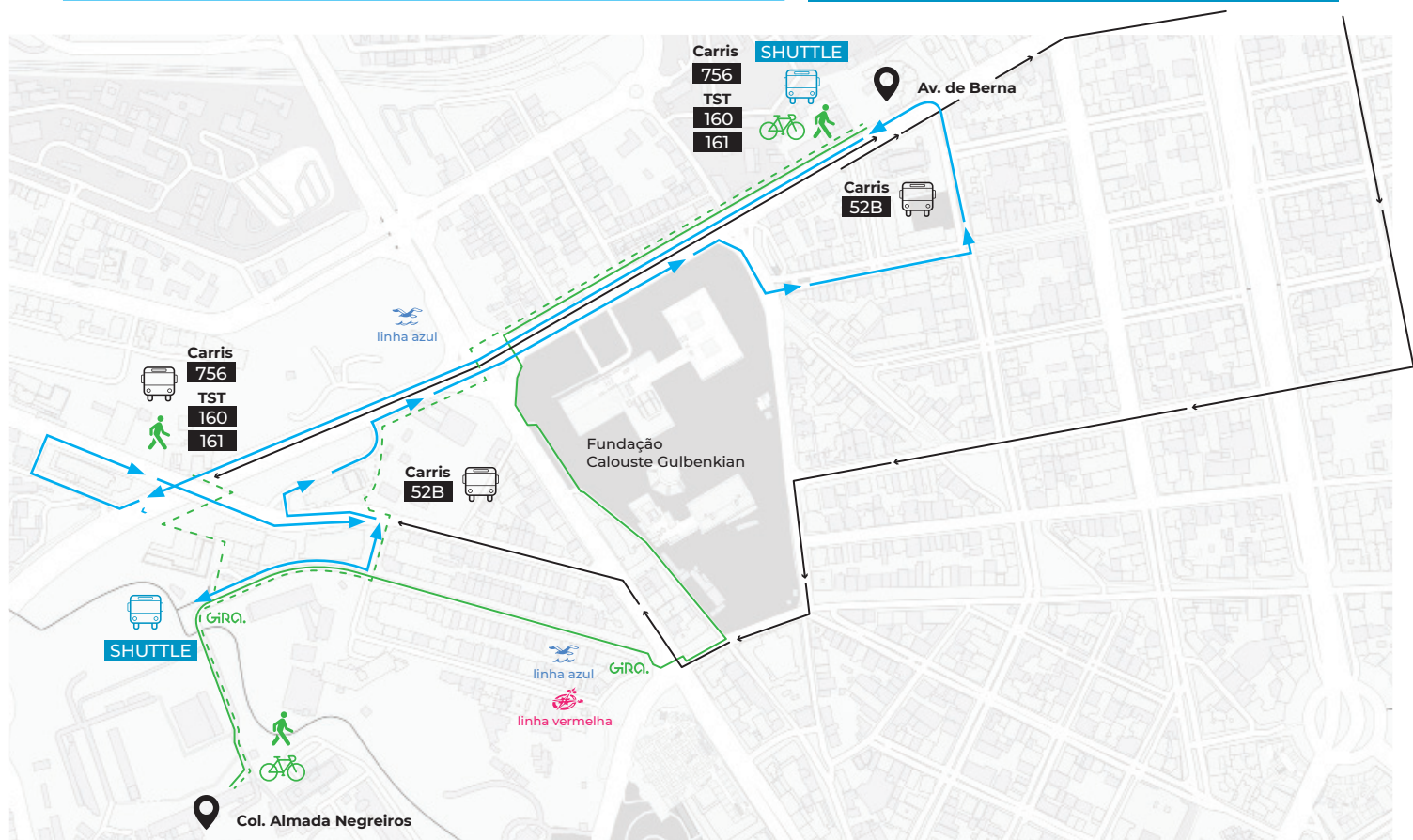

CAMPOLIDE Transport Network

Train



Sete Rios
Direct connection to the Subway blue line - Praça de Espanha station

Campolide
Carris lines:
756

Subway



linha azul
linha vermelha
São Sebastião station
linha azul
Praça de Espanha station

Carris



701
702
758

Carris Metropolitana



3703
3710



Bicycle park
and a GIRA.
docking station

CAMPOLIDE

MAP

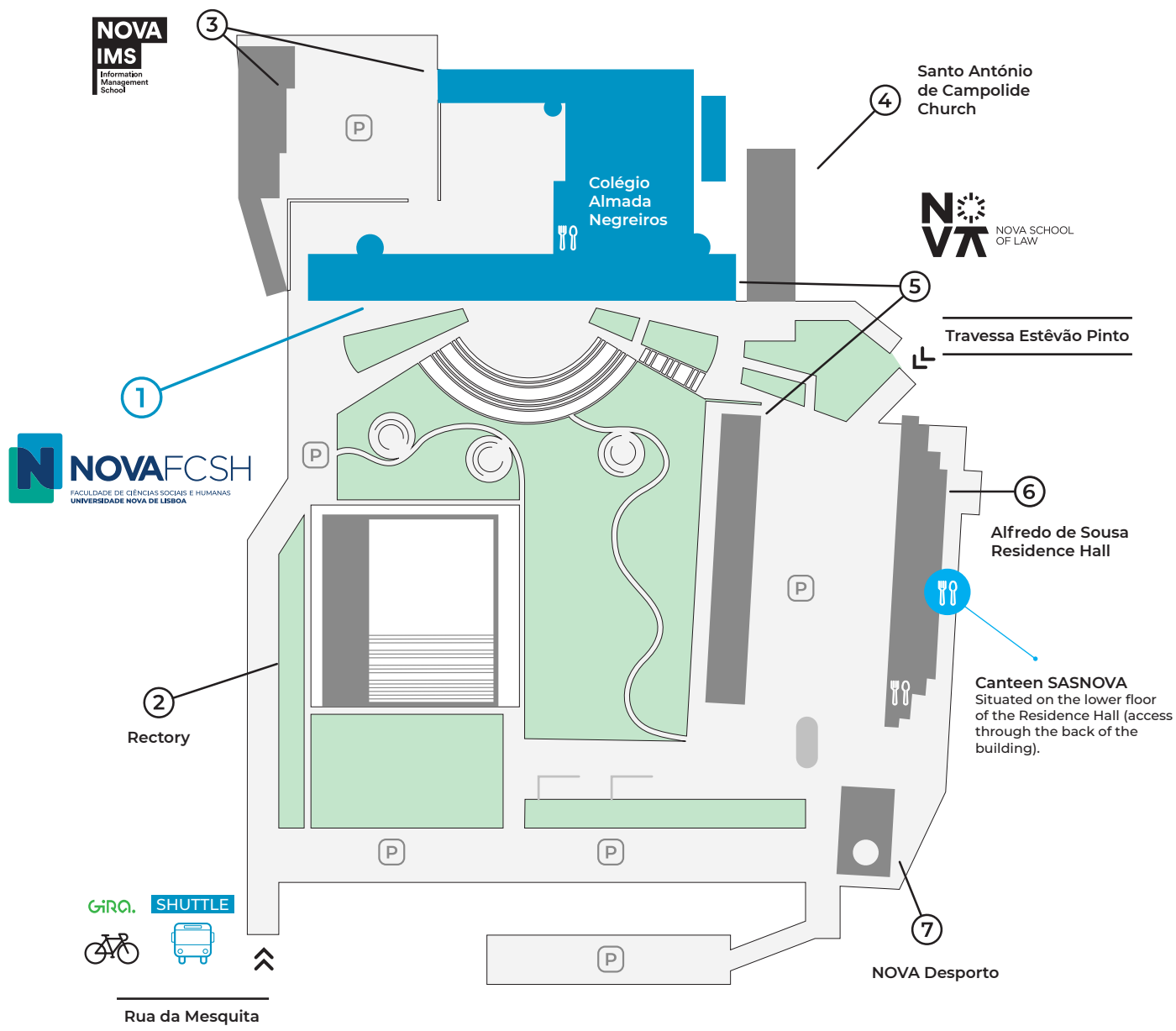

LEGEND



Bicycle park
GIRA



SHUTTLE

Shuttle stop
NOVA FCSH



Dining space



Canteen SAS NOVA



Park

COLÉGIO ALMADA NEGREIROS

3RD FLOOR

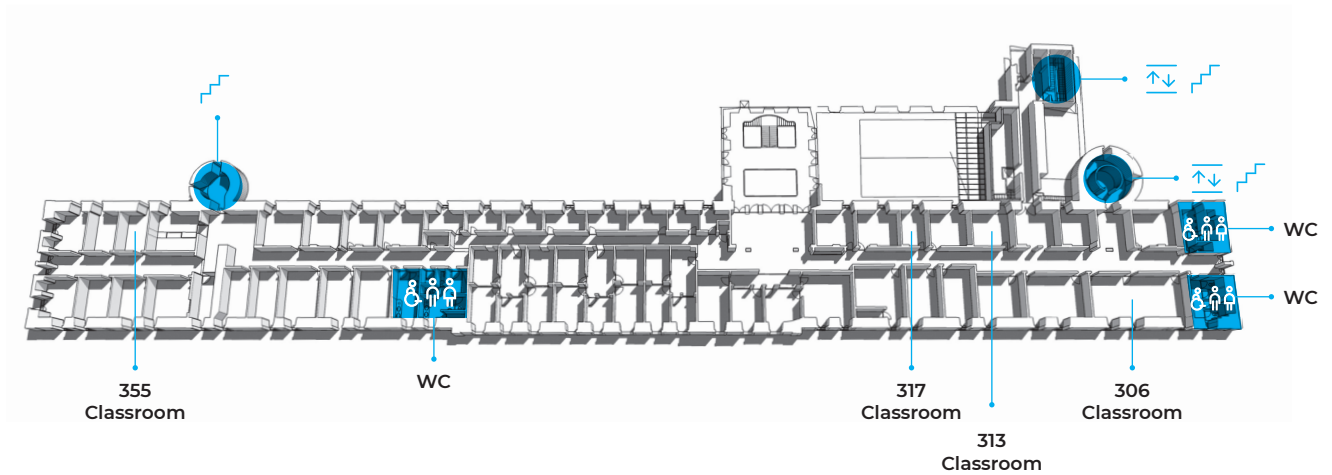

2ND FLOOR

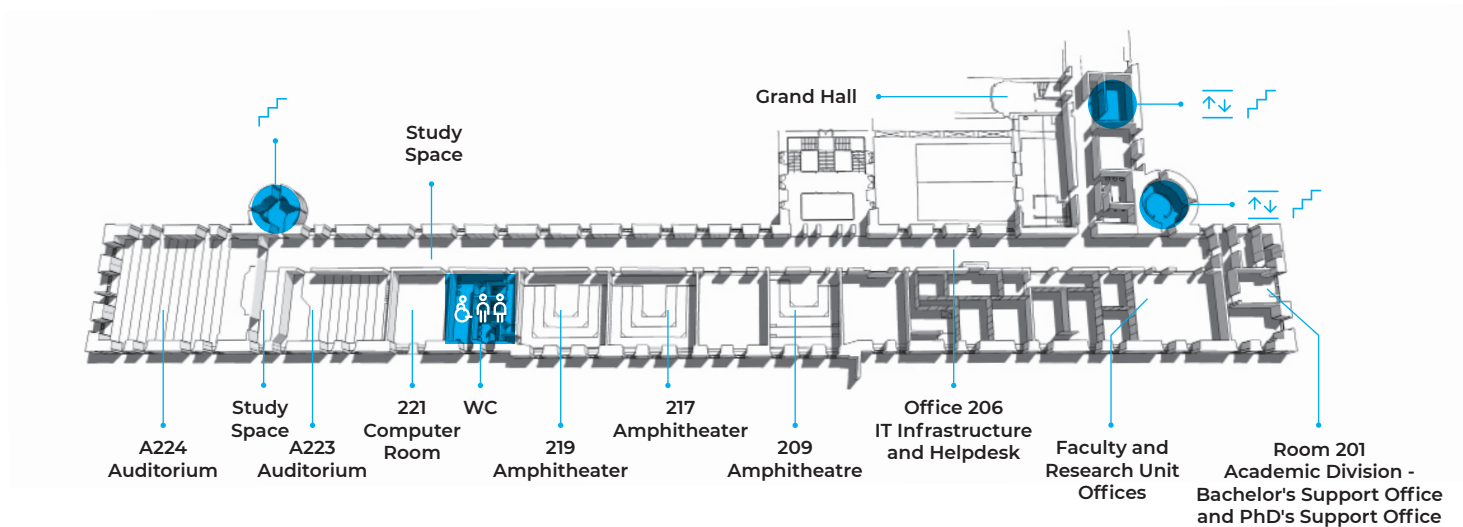

1ST FLOOR

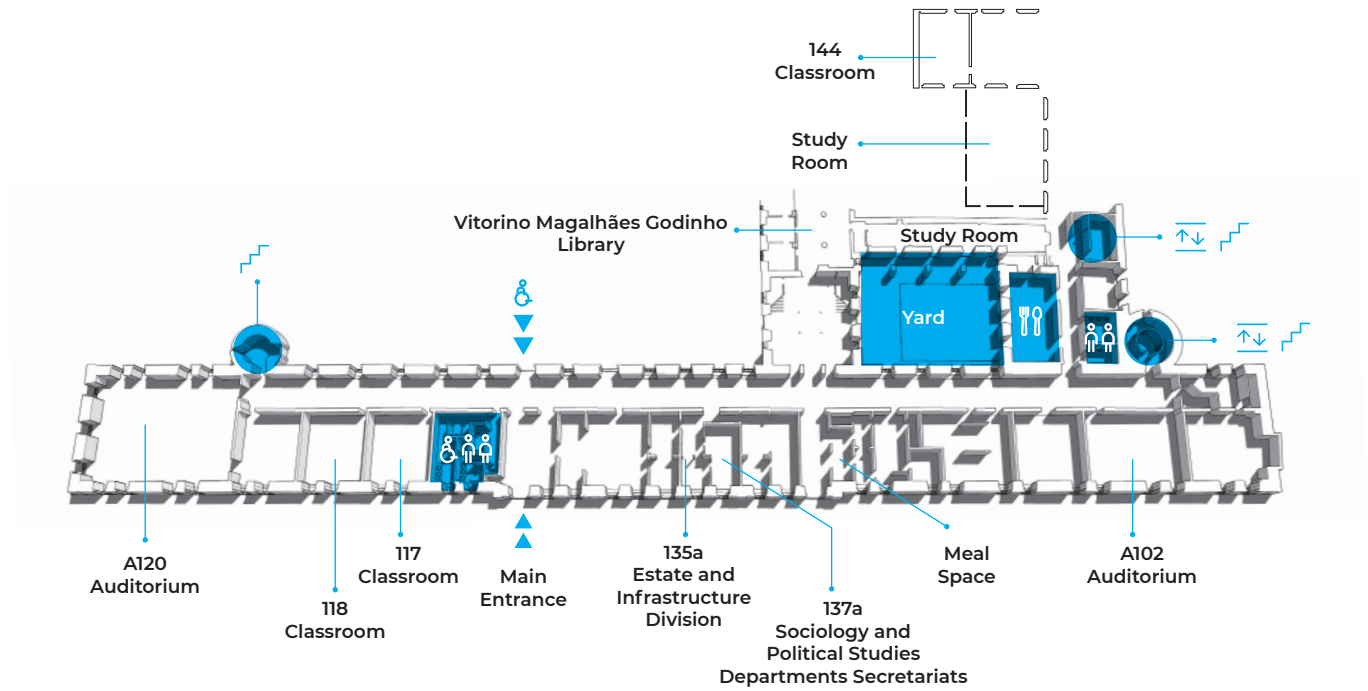

FLOOR 0

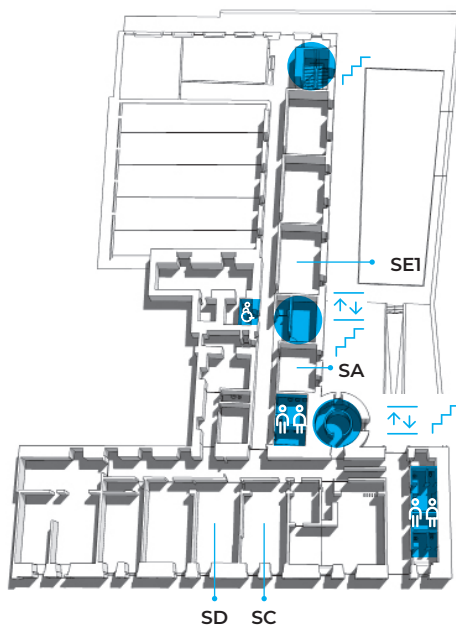

FLOOR -1

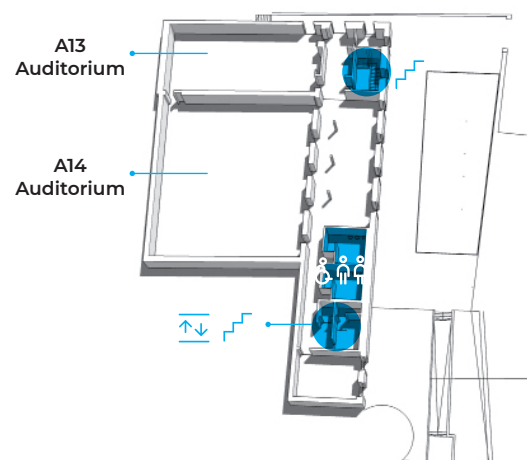

USEFUL INFO

ACADEMIC SERVICES

The Academic Services of NOVA FCSH will be located in room 201 of Colégio Almada Negreiros aiming to provide administrative support to all students.



Working Hours:

In person assistance

Mon and Wed 9.30am – 1pm

Tue and Thu 2pm – 6pm

Fri. closed

Phone service:

Mon to Fri 2.30pm – 4.30pm



Colégio Almada Negreiros,

Academic Services

Room 201 (2nd floor)

Bachelor's and PhD's Office Desk

Room 201 (2nd floor)

DEPARTMENT SECRETARIATS

The departments of Political Studies and Sociology are located in room 137A of Colégio Almada Negreiros.



Contacts:

sociologia@fcsch.unl.pt

estudos.politicos@fcsch.unl.pt



Working Hours:

In person assistance

Mon and Wed 9.30am – 1pm

Tue and Thu 2pm – 6pm

Fri. closed



Colégio Almada Negreiros,
Room 137 (1st floor)



IT SUPPORT

Almost all the computer services provided, being online, work equally in Colégio Almada Negreiros as in Av. de Berna - Infoestudante, email, Intranet, Moodle, Microsoft 365, wireless eduroam and access to scientific databases.



As in Av. Berna, at Colégio Almada Negreiros requests for computer support are addressed to the IT and Digital Transformation Division email: helpdesk@fcsch.unl.pt

In person support should be previously combined with the IT Support.

Contacts:

E-mail: helpdesk@fcsch.unl.pt

General - 217 908 300 ext. 40203

Ricardo Miguel Monteiro - 910 137 124 (8am - 4pm)

Paulo Grácio - 926 005 852 (11am - 7pm)



Working Hours:

Helpdesk

Mon to Fri 9am – 6pm

Support to Classrooms

Mon to Fri 8am – 7pm



Room 206 (2nd floor)



Shared space

INTERNET ACCESS ON CAMPUS

Wireless network

NOVA FCSH's Wi-Fi antenna park covers the campus. Libraries, auditoriums, computer rooms, classrooms, patio-terrace, bars and canteen have wi-fi coverage.

Access is made exclusively through the network eduroam, which is accessed with the FCSH ID credentials.

With these same FCSH credentials you can also access the internet at all Portuguese and European universities, since eduroam is the wireless network of European universities.

[Our page](#) allows you to follow all the steps to eduroam configuration for various operative systems.

NOVA FCSH's IT Services are available to provide technical support and answer questions that may arise.

Cable

In NOVA FCSH's study rooms there are network sockets to connect laptops. For this, you must use a UTP network cable and introduce the following data in the manual configuration of the browser network proxy:

Proxy: proxy.fcsch.unl.pt
Port: 3128

- In Internet Explorer, these fields are in:
Tools > Internet Options > Links > LAN settings
- In Firefox, these fields are in:
Tools > Options > Advanced > Network > Settings
- On Mac OS, this data is part of the Control panel network.

NOVA FCSH's internal network allows, from the outset, Internet access only via HTTP protocols and HTTPS (web pages).

Accessing external locations through other protocols (such as POP or FTP) is assigned upon request, to be made to the Helpdesk service of the Computer Core.

Email: helpdesk@fcsch.unl.pt

XEROX SERVICES

You can print your documents on the printers installed on the 1st and 2nd floor corridors.



1st floor next to rooms 135a 137a

2nd floor next to room 203



LIBRARY

The [Biblioteca Vitorino Magalhães Godinho](#) (BVMG) is a specialized library, dedicated to research, providing the bibliographic collections of 13 Research Units of NOVA FCSH.

The BVMG offers 3 research computers, 3 free-to-use scanners, and 1 multifunctional photocopier.

To register as a reader, it's necessary to access the [personal area of the Libraries' catalog](#) using the FCSH ID credentials (username: a + student number (e.g., a2023123123); password: the same one used for InforEstudante).



Library
Vitorino Magalhães Godinho

E-mail: bibliotecas@fcsch.unl.pt
Instagram: [@bibliotecasnovafcsch](https://www.instagram.com/bibliotecasnovafcsch)



Opening hours:
School term:
Mon and Fri 10.30am – 6.30pm
Tue, Wed and Thu 10.30am – 8pm

Holidays:
Mon to Fri 10.30am – 6.30pm



Colégio Almada Negreiros, 1st Floor

STUDY SPACES

There are several workspaces throughout the building.



- Room adjacent to the building's bar, where you will find individual work desks and electrical outlets (1st Floor)
- Tent, in the inner courtyard (1st Floor)
- 2nd floor hallway with double work desks and electrical outlets



Opening hours:
All these areas are freely accessible to students.
Mon to Fri 9am – 10pm
Sat 9am – 6pm



CLASSROOMS

Examples of some spaces where classes will be taught.

- 1 Grand Hall
- 2 Amphitheaters
- 3 Classrooms

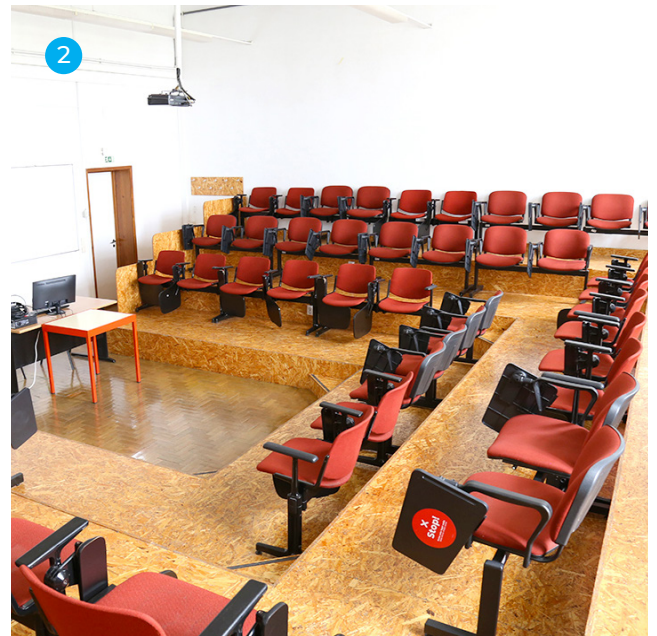

CANTEEN AND BARS

The SASNOVA canteen is located near the Alfredo de Sousa Residence and practices the same prices as Av. de Berna's.

Inside the Colégio building there is a privately explored bar that serves meals at lunchtime.

You can heat up your meals in the microwave located in different areas of the building.





Send your questions and suggestions to
campolide2022@fcsh.unl.pt